



HAND CRAFTED BY AUSTRALIA'S MOST AWARDED LUXURY MOTOR YACHT BUILDER



Escape, on a whole new level

Riviera Flybridge Collection - first class all the way

In business the view from the top has many perspectives: uplifting, time constraining, always challenging. Come on, you've earned a break.

Another view from the top awaits. And it is calling you now. This is a world filled only with happiness and success: family and friends, luxury and renewal, unforgettable memories and joy.

At the helm of your magnificent new Riviera Flybridge luxury motor yacht, you oversee a world of unsurpassed beauty and grace, where life glistens and shines.

Any of the yachts from the Riviera Flybridge Collection, the 52 or 57 Enclosed Flybridges or the 43 or 45 Open Flybridges, can effortlessly fly you and your loved ones here.

You will be traveling in sublime blue-water style. With world renowned craftsmanship and quality, space, light, luxury, breathtaking accommodation and thoughtful inclusions at every turn. All underpinned by superior strength and build, astonishing stability and spirited performance.

Welcome aboard the world renowned Riviera Flybridge Collection. What a way to fly.



Rodney Longhurst - Owner Riviera









Riviera 57 Enclosed Flybridge: escape, on a whole new level

The more time pressured modern life becomes the more precious escape becomes. So has there ever been a better feeling ... time better spent ... than striking out for blue-water with friends and loved ones onboard your new Riviera 57 Enclosed Flybridge.

This is pure unadulterated escape – escape on a whole other level of luxury and indulgence. Three levels in fact ...

Escape made even more enjoyable by an astonishing array of intuitive technical virtuosity serving all needs onboard, whether you're skipper, host or guest. The expectation of great sights, good times and memories lie ahead. And there's no better feeling than watching smiles appear and stress disappear, as you slide further and further from shore.

The Riviera 57 Enclosed Flybridge is a superbly designed craft. As beautiful as she is structurally strong. And being an Australian-built Riviera, she will power dreams of escape for decades to come. Over three levels of luxurious,

handcrafted, on-water living, she will inspire and delight you with more space, more light, more headroom than you thought possible. Generous. Unprecedented.

Above and below, that unmistakeable Riviera attention to detail impresses: fastidiously polished, handcrafted timberwork, gleaming stainless steel door frames and rails, spectacular surround glass and views. It's all been designed to create a superior quality of life. And it succeeds spectacularly.

The Riviera design team offer you two options from industry-leading, Volvo twin pod-drive propulsion systems to power your dreams. Linked to large touchscreen and navigation displays housed in the luxurious flybridge helm, it all works in harmony to make the Riviera 57 the most innovative and easiest-to-skipper motor yacht in its class.

Every great escape starts here

Cruisers, entertainers, adventurers, anglers: with the selection of your preferred options at build stage, the Riviera 57 can realise every owner's individual dream. And they all commence here, at the ultra wide boarding platform.

The strong double transom doors open out to extend the cockpit living space and make access easy from port or starboard. So now you're onboard, all set to escape, but before you do, take a moment to appreciate Riviera attention to design detail. There's the truly impressive dimensions, abundant storage and refrigeration compartments, the large glass sliding door and awning window forward that, when opened, will link this cockpit space to the saloon inside creating one seamless, expansive whole. It all constitutes a magnificent, flowing and thoroughly enjoyable way to savour life onboard.

The sheer size of your Riviera 57 cockpit offers enormous lifestyle advantages. Large enough to introduce occasional furniture to welcome and entertain loads of guests, big enough to accommodate a club of keen anglers and all their gear ...

Riviera designers have made true cockpit flexibility central to their design vision. So, keen anglers can specify a game chair thanks to the inbuilt alloy plate in

the cockpit floor, just as easily as the cruising family can insist on a superbly finished timber dining table.

Here, in a cockpit outfitted for cruising, dreams of escape take on fabulous reality. Look, that's highly finished teak decking, soft and luxurious underfoot. And overhead, a sweeping, stainless steel- framed awning shades the mezzanine space - inspired yet practical; very Riviera.

Now picture friends and family laughing, sharing and unwinding. There they are now, gathered on the plush, L-shaped mezzanine lounge around the handcrafted cockpit table, trading remarks with more guests seated on the optional transom lounge opposite. And there you are too, off to starboard, tongs in hand at the gourmet double barbecue centre, complete with drawer-style fridge, ice-maker and sink.

These are the 57 escapes dreams are made of. The only question is ... will you ever want to come back?









Great storage, safe passage, more entertaining

The Riviera 57 Enclosed Flybridge is a superbly designed craft high on practicality and lifestyle choice for owners. Take the sweeping foredeck area. It offers you the option of a davit and storing your tender here or, courtesy of a large sun pad, transforming the space into another onboard entertaining area with frequent out-of-this-world views.

No wonder your 57 foredeck can be a powerful attraction for all manner of guests, children and pets among them. Safe passage is assured courtesy of wide side decks featuring thoughtfully placed handrails, a high bowrail that runs well aft and raised, toe-kick bulwarks. And because high practicality and fine appearance should work together, you will note that the bow rail is highly polished, marine grade 316 stainless steel, as are all the exterior fastenings like cleats and fender holders.

Deep anchor lockers store the anchoring equipment thoughtfully hidden from view and the elements, yet close to hand when needed. Should you decide to store your tender on the boarding platform, you can exercise another option to create a private solarium area by fitting a soft, comfortable double sun lounge with stainless steel rails. It is a great place to escape.

Then again, so is the entire craft.

Come on, join us on the inside

The Riviera 57 Enclosed Flybridge boasts a generous beam. Quite clearly, it opens up a whole new dimension of design and living possibilities.

Consider all you survey here. A fine roomy galley transforming into an ultra desirable saloon space, all surrounded by ever changing views of such quality and variety they're most often reserved for five star hotels and restaurants.

The rear saloon bulkhead of your 57 consists of tinted and tempered glass set in a polished stainless steel, ship-like frame. Solid? Very. Close it - and the awning window aft from the galley - and you are luxuriating in an exclusive sanctuary. But leave the bulkhead and window open, and here in the galley - with its stainless steel appliances, spacious benchtops and wonderful cabinetry - you are at the centre of everything.

Conversing with cockpit guests, passing comments and fine delicacies to those in the saloon or the cockpit ...

Saloon living on a grand scale

Picture looking up from reading your book to spy an albatross hovering just above the water in the near distance, filling the view from your surround glass windows. That's a Riviera 57 saloon moment.

Watching first-time guests enter this generous space, turn their heads side to side and take in the uninterrupted sight from bow to stern, port to starboard. Their reactions sparkle with delight. That's another Riviera 57 saloon moment.

This is your luxury waterside retreat, blessed refuge and entertaining mecca all in one that puts a whole other level of 'style' into lifestyle. Over the years at many different ports and anchorages, a wonderful assortment of dinner guests are sure to applaud your choice of cruising yacht.

And just wait until you experience the saloon ambience and timeless inclusions first hand!









Your masterful retreat

Time to rest after all that entertaining, swimming, fishing, and unwinding? The accommodation deck beckons. Descend the wide companionway from the saloon and luxuriate in the wonderful natural light flooding in from the atrium above.

Take note that concealed behind the companionway's beautiful cabinetry both your washer and dryer reside.

Just a half turn from the main companionway, lies a world entirely apart: your master stateroom.

Riviera designers have taken the overriding theme of 'escape' then added layer upon layer of luxury and flair, taking advantage of the extra space afforded by full beam proportions

This is a wholly welcoming, breathtakingly generous space, a sanctuary where elegance and amenity are writ large. Quite simply you'll want for nothing. An experience enriched by the world class views outside your stateroom windows.

Needless to say, your bed is king-sized and walk-around with generous storage beneath.

Speaking of storage, look no further than the superbly finished Riviera cabinetry along both perimeters - practical yet beautiful. Those striking timber panels behind the bed make a formidable design statement. And you're sure to relish the cedar-lined, walk-in robe with automatic lighting. Are you being spoiled? Absolutely.

Please, take a seat in the master lounge to port and contemplate all that is before you. Natural light filters in from long sweeping hull windows highlighting soft, rich fabrics and master-crafted timberwork. It all adds up to

an air of restful luxury - a wonderful antidote to the pace of modern life.

Choose air conditioned comfort or refreshing sea air from the optional opening portholes. Push a button to enjoy your state-of-the-art home theatre system. And could there be a finer sight than opening the blinds to sunrise afloat? Rest assured, between the inspiration of Riviera designers and the marvels of nature, escape has never felt so good.

A master designed ensuite

Aft and designed on a complementary theme of grand elegance is the master ensuite. Just as our designers have gone beyond in creating your stateroom, they have similarly excelled here in the master ensuite.

Fresh from the pages of a fine designer magazine, you have much to look forward to. Classically proportioned yet boasting the most contemporary appointments, it is a triumph of form and function: luxurious, elegant and practical.

That's fine timber flooring at your feet and LED lighting overhead and framing the vanity mirror. A handcrafted Riviera cabinet houses your bathroom essentials and note the handsome solid surface benchtop and shapely vanity basin. And the spacious frameless shower stall next door? Well, it performs as well as it looks.

The master ensuite of the Riviera 57: sheer luxury, on a whole other level.



Your very impressed guests

The wonderful experience of owning a Riviera 57 Enclosed Flybridge demands to be shared so our designers are just as passionate in creating an unforgettable cruising experience for your guests, most particularly with their accommodation.

The forward VIP guest stateroom is a shining example of our design team's devotion to handcrafted quality, craftsmanship, attention to detail and superior finish.

The first time your guests see the queen-sized, walk-around bed, feel the plush pile carpet underfoot and admire the handcrafted cabinetry which conceals generous, cedar-lined hanging and storage space, they'll know immediately ...you hold them in the highest regard.

This is a large and impressive space with bedside tables to port and starboard and even a vanity compartment. Your family and guests will love this stateroom's special ambience, its expansive hull windows framing inspired views and the choice of air conditioned comfort or fresh air from dual deck hatches.

Superbly appointed and fully self contained, the VIP stateroom also features its own home theatre entertainment system. Next door is the VIP-standard ensuite with all designer facilities, including a frameless shower stall. With two-way entry, it cleverly doubles as the day head.





Everyone looked after in style

Your Riviera 57 opens up a sparkling array of blue-water escapes. Fortunately, Riviera designers have anticipated your need to accommodate extra guests, children or grandchildren eager to sample all she has to offer. As befitting a craft of this size, now you can accommodate and pamper extended family in true comfort and style.

Naturally, being Riviera, they will be treated to an enviable degree of refined luxury in your third bedroom option - the starboard twin stateroom.

Your guests will discover adult-sized upper and lower beds, LED reading lights, stunning Riviera cabinetry including a cedar-lined hanging locker with LED lighting and drawer storage ... and completing the luxury experience, the twin stateroom's own home theatre with stereo and iPod interface.

Here, as with all three levels of this ultimate escape craft, the sophisticated Riviera brand of 'luxury meets practicality' inspires and enchants.

Of course, as proud owners and hosts, it's not only your guests who are impressed...





The view from the top

Access to the flybridge area is a typical Riviera work of art ... a stylish floating internal staircase with teak treads. A pleasure to climb and very rewarding once there. This fully enclosed flybridge is a revelation - a spacious mix of sublime comfort, peerless visibility and technical excellence.

You are in a commanding position that makes reading and adjusting to prevailing sea conditions easy, even in rough weather. Here it's simple to safely navigate your chosen course.

That of course is a matter for skippers and first mates. If you're simply keeping them company, taking in the spectacular flybridge views, we want you to totally relax. So please, take your place in the enormously comfortable L-shaped lounge to port, with its highly polished entertainer's table.

There is also a luxuriously deep chaise seat forward for those wishing to be adjacent to the helm.

Temperature to your liking? If not, we'll adjust the reverse cycle air conditioning. Or perhaps you'd like us to activate the electric sunroof and soak up that sunshine? Drink? No problem. There is a wet bar aft with secure bottle storage and a sink. Feeling peckish? Send your order via intercom to the galley.

Aft is the rear awning window and sliding door - both set in strong, highly polished stainless steel frames, just like in the saloon - opening out to the rear flybridge deck. Here you'll find another lounge and your aft docking station, which you could enclose by fitting clears with zipper-opening panels.

And because the mood up here is so often joyous and celebratory, feel free to enliven proceedings further courtesy of the four speaker CD/DVD entertainment centre with its helm remote.





Step forward and take command

Feel confident and at ease in command of a luxury modern motor car? Then welcome to the helm of this fine luxury motor yacht. A wealth of the most astonishing modern technology makes it touchscreen-easy to operate, even for novice skippers. It's uplifting. Life affirming. And simply exhilarating.

Slide into the supremely comfortable, fully adjustable captain's chair and experience unmatched visibility from three large clear, tempered glass windscreens. Now take hold of the sporty leather steering wheel. You're all set to go. Everything here has been designed to make you a master of all that you command.

And down in the spotless engine room below, Volvo Penta's innovative twin pod-drive engine systems power your every escape.

Simply take your cues from the large multi-function display screens in front of you. The world's easiest-to-follow, luxury motor yacht instrumentation allows you to take in full vessel, steering and propulsion controls - plus navigation and engine system monitoring - at a glance. Simple.

Here at the helm of your glorious Riviera 57 Enclosed Flybridge, you're flying first class all the way.

Engineering excellence

The flow-coated engine room, with acoustic and thermal insulation and LED lighting, can be accessed through a hatch in the 57 Enclosed Flybridge's cockpit mezzanine floor which, even when open, maintains walk-through access to the saloon.

An advanced mist elimination system with veins draws moisture from the air and feeds directly overboard. All onboard drains including air-conditioning compressors feed into the common drain lines located on either side of the yacht and drain aft. Four automatic bilge pumps with manual override are located at various points throughout the hull and pump directly overboard.

There's even plenty of space for a gyroscopic stabiliser down here — another example of how Riviera is always ready to embrace innovations that make boating even more enjoyable.





Electrical excellence

All batteries aboard the 57 Enclosed Flybridge are maintenance-free and are individually housed in special battery boxes in accordance with American Boating and Yacht Council (ABYC) standards, as well as the European Union's CE conformity mark, which incorporates the International Organization for Standardization's ISO guidelines.

The 57 Enclosed Flybridge includes six house batteries, self-monitoring Mastervolt charging system, plus dedicated engine alternators for each battery bank.

Additionally, 24-volt house power with house battery bank measuring 675Ahr AGM allows for simpler charging, lower current draw and smaller cables, providing reduced weight when compared to equivalent 12-volt systems.

The 57 Enclosed's standard Mastervolt AC-DC inverter (5kW 230V 50HZ/4kW 110V 60HZ) provides power to the icemaker, entertainment systems and all outlets onboard, ensuring watching television while relaxing quietly at anchor or in a marina is whisper-quiet.

LED lights also provide trouble-free boating while reducing electrical current draw. The lamps use less than 10 per cent of the power required to run a bulb lamp — no bulbs mean no maintenance and long service life.

Additionally, Residual Current Device/Ground Fault Circuit interrupter (RCD/GFCI) protection is installed throughout the entire yacht and complies with stringent international standards for safer boating.



The power and technology

The Riviera 57 Enclosed Flybridge employs the revolutionary Volvo Penta D13-IPS1200 system with twin D13 engines and IPS30 pod-drives (2 x 662kW/900hp)

— Includes low-speed mode, Dynamic Positioning System, Auto Pilot, Active Corrosion Protection, twin lever electronic controls at the helm, joystick controls at the helm and in the cockpit as well as 3 x 17-inch Glass Bridge touch-screens.



Window to the future

State of the art touch screen navigation systems very much confirm Riviera's commitment to enhancing your time aboard.

The blend of technology, dependability and easy to use functionality places the Riviera 57 Enclosed Flybridge at the very forefront of world-class recreational motor yachts of this size.

Volvo Penta's Inboard Propulsion System (IPS) offers easy joystick maneuverability, Dynamic Positioning System for station-holding while preparing lines and fenders or while waiting off a fuel jetty, as well Active Corrosion Protection and Auto-Pilot.

However, Volvo Penta's Glass Cockpit takes the overview and control of engines and navigation, including optional charts, sonar and radar (even auto-pilot) to extraordinary new heights...and all in one place.

It also extends to auto-trimming and full joystick steering whilst under way, as well as the outstanding maneuverability of SportFish mode, and the clean presentation of bait using the bypass exhaust features of Clear Wake.



IPS features progressive rate steering, twin lever electronic controls and joystick controls at the helm and in the cockpit on either the port or starboard sides. Joysticks enable low speed steering and also assist with easy docking of your yacht.

IPS systems have twin three blade nibral, counter-rotating propellers that are protected against wear by the premium coating Prospeed, and have stainless steel line cutters for protection from fishing lines, plastic bags and nets. These precision made line cutters create a very efficient cutting action to protect the propellers and shaft sealing without increasing drag or fuel burn.



The Riviera advantage

Riviera is continuing to lead the luxury motor yacht market and proudly stands behind the easy-to-use systems onboard its world-class designs.

A 5-year limited warranty on all Volvo Penta systems is now standard with every new Riviera and covers Volvo Penta helm stations, steering and propellers as well as major componentry of their high performance drivelines and fuel-efficient engines.

Available worldwide, this extended warranty complements the Riviera 5-year limited structural warranty and will provide even greater peace of mind for our valued Riviera boating family members.

Riviera Family members enjoy exclusive invitations to fun-filled social and boating education events, inspiring cruising experiences as well as special offers on genuine parts, electronics and our premium Riviera lifestyle collection.



CZone simplicity

The fully integrated CZone digital switching system enhances the ease of monitoring and operation of the Riviera 57's onboard systems including tanks, and extends centralised, touch-screen control to lighting, pumps, batteries, entertainment systems and appliances.

CZone allows owners to operate multiple circuits at a single touch, energising all lighting and electrics depending on your requirements. It comes pre-programmed with three modes — “entertaining”, “cruising” and “dock unattended” — and these modes can be customised to suit your requirements so the system works exactly the way you want it to.

Other user-friendly features include interior light-dimming, timer controls, automated circuit control, wiper speed and wash functions. There's also a “service” mode that shuts down all power and systems.

Based on industry-proven Controller Area Network (CAN) technology, the CZone system offers DC and AC switching and over-current protection. Full systems monitoring (with alarms) including AC voltage, current, frequency and kilowatts, DC voltage, current and remaining battery capacity, along with fluid tank levels and indication for systems in operation, is all clearly displayed on the 3.5-inch touchscreen at the helm and 10-inch colour control screen at the saloon entrance.

There's also the option of additional iPad connectivity, so you can control CZone from anywhere onboard your yacht.

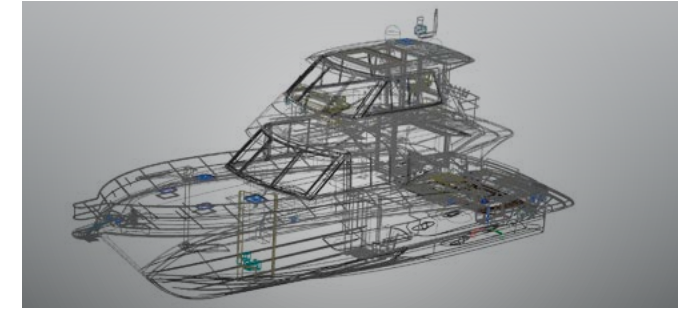

Impeccable pedigree

The confident poise of the 57 Enclosed Flybridge is just as evident offshore as it is at anchor — her solid and robust hull with keel is the evolution of our rich 38-year heritage of building over 5300 world-class luxury motor yachts that are proven in the often challenging Australian offshore conditions.

Every Riviera built at our world-class facility on Australia's Gold Coast combines superior-strength hand lay-ups with a water-tight collision bulkhead forward and independent compartments throughout the hull.

Our legendary build quality also features vinylester resin in the outer layer of lamination to increase the ability to withstand water absorption. An isophthalic gelcoat exterior provides an impeccable and hard-wearing surface finish.

From the waterline down, the hull is solid GRP with reinforced bottom, keel and chines. Structural core material is used in the hull flanks, main deck and hardtop, while precisely fitted, lightweight resin transfer-moulded small parts have a double-sided gelcoat finish and are pre-fitted for a perfect seal when all major components are bonded together.

Riviera only uses 316 marine grade stainless steel in all our exterior fastenings. All stainless steel rails feature ground and polished welds to ensure a consistently smooth and mirror finish.

Our designers have also placed a firm focus on convenient access to every key maintenance point so any issues can be quickly identified and addressed, and service costs are kept to a minimum.

Riviera 57 Enclosed Flybridge

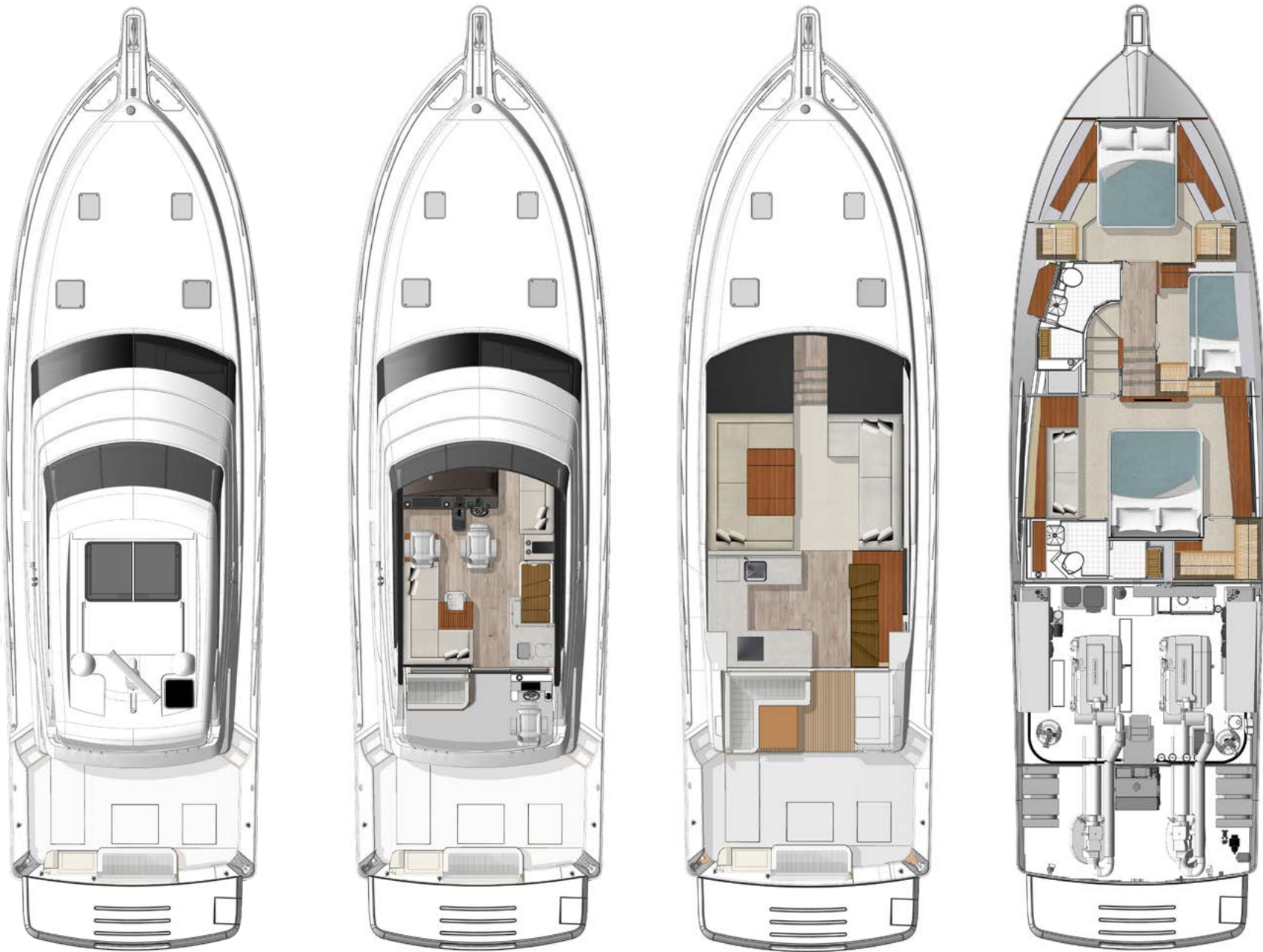

Optional storage bin and transom lounge

Optional gyro

Specifications

Length Overall (inc. swim platform and bow sprit)	18.50 m	60' 8"
Hull Length (Lh to ISO8666) *	17.20 m	56' 5"
Beam (inc. gunwale)	5.13 m	16' 10"
Maximum Draft (inc. props)	1.58 m	5' 2"
Dry Weight (approx.) **	29,985 kg	66,106 lb
Fuel Capacity ***	4,000 L	1,057 US gal
Water Capacity ***	750 L	198 US gal
Holding Tank Capacity ***	500 L	132 US gal
Sleeping Capacity	6 persons	
Cockpit Area	8.75 m ²	94.18 ft ²
Mezzanine Deck	3.60 m ²	38.75 ft ²
Total	12.35 m ²	132.93 ft ²
Bridge Clearance	6.95 m	22' 10"
Standard Engine		
Volvo Penta D13 IPS 1200 x 2	662 kW	900 hp each

*Specifications may vary on a regional basis.

Specification clarification

* Length of the hull (Lh) to ISO8666: Includes all structural and integral parts (ie. the moulded length of the hull). It excludes parts that can be removed in a non-destructive manner without affecting the structural integrity of the craft, (eg. pulpits, outdrives, driving platforms, rubbing strakes).

** Dry weight represents the estimated minimum weight of a yacht with standard engines and options, no fuel or water on board, no equipment or provisions and no personnel. The stated dry weight may be exceeded.

*** Denotes net tank capacity. For useable capacity do not rely on more than 90% of tank capacity. Actual capacity will vary according to yacht trim and sea state. Speeds are subject to normal weather conditions, fuel and/or water levels, passengers and equipment loads.

Our care for your information

Due to the constant refinement of specifications and design by Riviera Australia, the information in this document may change without notice.

Specifications may vary with time and by region.

Some images or illustrations in this brochure may include options or custom details.

Please note that as safety equipment specifications or standards vary by country, this aspect of your purchase will need to be completed by yourself and or your Riviera representative.

Please refer to your Riviera representative for specific warranty cover and the latest detailed list of inclusions and options prior to purchase.

The Reassurance of owning a Riviera

What sets Riviera apart as one of the world's great luxury motor yacht builders?

Is it the devotion to quality, standard of materials used, the ocean-tested structural strength, unsurpassed ease of operation, or the stylish, handcrafted luxury finish? Or perhaps it's the famous culture of care that transforms owners into the 'Riviera family'.

The answer is all of the above, and more. Much, much more. Over 40 years and the building of over 5,600 luxury motor yachts, the 600-strong Riviera team have been on a continuous quest of evolution and refinement.

This remarkable heritage of knowledge matched by innovation allows us to marry the best of the time proven with the exciting and new. Witness our introduction of cutting edge touch screen digital technology and joystick maneuverability, which make navigating and operating a Riviera and Belize luxury motor yacht a relaxed and enjoyable experience.

Located on the Gold Coast, Queensland, our 14-hectare, state-of-the-art manufacturing facility is the largest facility of its kind in the Southern Hemisphere. Here we build on the notable Australian qualities of strength, practicality and love of water in the continent completely surrounded by three oceans and four seas.

Then we test our designs in some of the toughest offshore conditions on earth. Hardly surprising that Riviera luxury motor yachts command impressive resale values worldwide.

Today, you can choose from five individual designs that make up our fabulous collection of luxury motor yachts, the Riviera Flybridge, SUV, Sport Yacht or Sports Motor Yacht models, along with our more traditional Belize Collection. All will withstand virtually anything the elements and you can put them through, with poise and ease.

Naturally, we back this confidence with an industry-leading 5-year structural limited warranty. In addition, with all our Volvo Penta powered yachts, we offer a 5-year limited warranty covering helm station controls and multi-function displays, steering and propellers, plus pod drives and engines.

Life is too short for needless compromise. So when it comes time to invest in your dream motor yacht, why settle for a lesser option when you can enjoy all that makes up a Riviera.



The pride of mastercraftsmanship

Owner-care at Riviera and Belize is in a class of its own. Premium quality, professional and personal, it is all designed to be of the highest quality, in keeping with the world-class luxury motor yacht we are building specifically for you.

Like thousands of other happy owners, we are confident your every experience of dealing with us and our global representative team - from selecting your favoured options, electronics and decor, through to routine maintenance and repairs - will be conducted with the upmost respect and care.

Our highly skilled team consult and partner with internationally acclaimed naval architects, designers and engineers to ensure we fully embrace the latest, most exciting industry standards and trends.

Constant communication with the worldwide family of Riviera owners also plays a vital part in helping guide and inform our new model development program.

All this pride in our designs and craftsmanship ensures Riviera will continue to exceed the evolving needs of discerning luxury motor yacht enthusiasts like you.



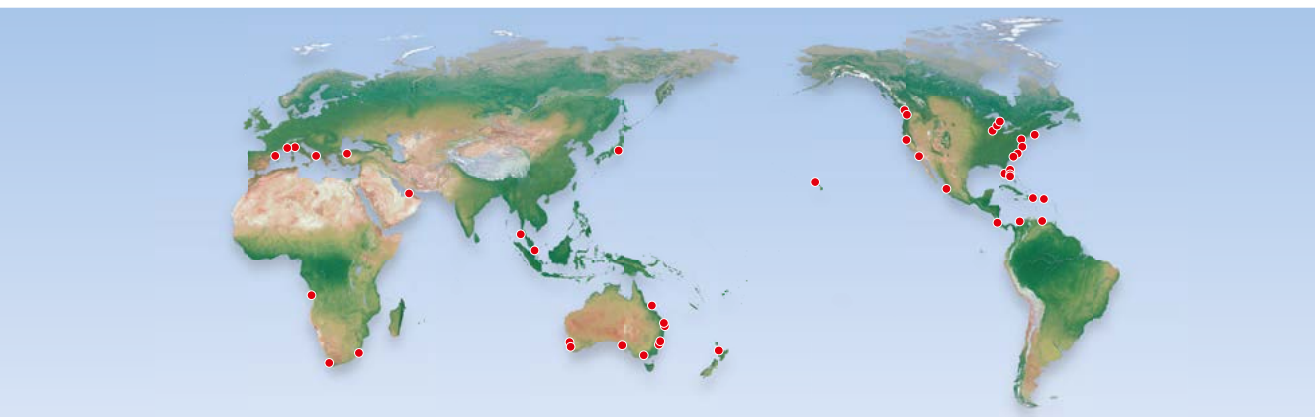

A global marque of excellence

For nearly four decades the Riviera team have been focused on the relentless pursuit of excellence. That means never being satisfied with the status quo, rather forever looking to improve and refine our knowledge base by embracing the latest technologies and work practices.

All these endeavours by our factory team and international representative network are directed towards creating a superior luxury motor yacht experience for you. They have also garnered us enormous acclaim from the global boating industry and specialist media along the way.

Over the past four decades Riviera have accumulated an impressive collection of local, national and international awards recognising 'world's best practice' across the fields of education and training, employment, innovative manufacturing techniques, export, quality of workmanship and pioneering design.

More than testimony to our passion for handcrafting superior luxury motor yachts, they are your assurance when you decide to own a Riviera motor yacht.

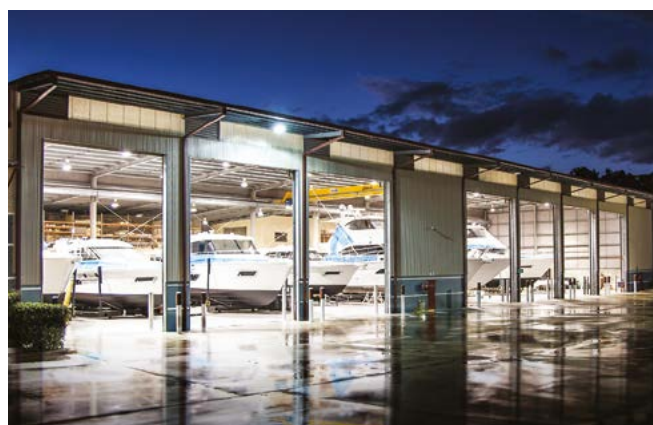

Systems and Technology

Electronics play an ever-increasing role in maximising the pleasure and safety of luxury motor yachts, and the choice of equipment that is available today is vast.

Selecting the equipment that meets your needs can be a challenging task — and Riviera's electronics experts are here to assist.

We source the best systems from around the world, we help match technology to individual requirements and work closely with Riviera's international representative network to create systems that maximise your boating pleasure.

Genuine Parts, Decor and Accessories

Our passion for quality and practical design is reflected in our exclusive and growing range of clothing, accessories and décor items created to enhance your lifestyle.

If you love your Riviera, you'll feel right at home with the Riviera Collection — an extensive range of casual, stylish, comfortable, practical equipment, clothing and accessories.

The Accessory and Décor collection ranges from storm jackets to stylish crockery and glassware.

To make your Riviera truly your own, we offer a wide range of fabrics, finishes and colour schemes that enable you to personalise your motor yacht.

Of course our experienced design team is always available to advise and assist you with your individual selection.

RivieraParts.com.au





The Riviera Experience

There's nothing quite like the exhilaration of blue-water cruising in company to remind our valued owners why they are so passionate about the rich and rewarding Riviera luxury life afloat.

For these are the types of passages that build the confidence and skills for people to use their yachts to their full potential, that create the very special memories that last a lifetime, and, importantly, are often the catalyst for long-lasting friendships.

Together, members of our growing global family of Riviera and Belize owners enjoy many special cruising experiences to idyllic destinations around the world — safe in the knowledge that experienced skippers and engineers are always close at hand.

We invite you to join with us for these special experiences — either to stretch your sea legs and gain offshore cruising confidence, or to simply enjoy the company of like-minded people who share an appreciation for the truly unique Riviera life.

The Evolution of Riviera - Since 1980



Constant refinement and innovation has created an Australian triumph



2018 - Belize 66 Sedan



2018 - 39 Sports Motor Yacht



2018 - 395 SUV



2018 - 72 Sports Motor Yacht



2017 - 68 Sports Motor Yacht



2016 - 4800 Sport Yacht



2016 - 575 SUV



2016 - 5400 Sport Yacht



2013 - 63 Open Flybridge



2013 - 50 Enclosed Flybridge



2012 - 445 SUV



2012 - 75 Enclosed Flybridge



2012 - Belize 54 Daybridge



2011 - Belize 54 Sedan



2011 - 4400 Sport Yacht SII



2011 - 61 Enclosed Flybridge SII



2008 - 56 Open Flybridge



2008 - 51 Enclosed Flybridge SII



2008 - 48 Offshore Express



2008 - 4400 Sport Yacht



2008 - 38 Open Flybridge



2007 - M470 Sport Cruiser



2007 - 4700 Sport Yacht



2007 - 45 Open Flybridge



2004 - 33 Open Flybridge



2003 - 58 Enclosed Flybridge



2003 - 47 Open Flybridge SII



2003 - 42 Open Flybridge



2002 - M370 Sport Cruiser



2002 - M290 Sport Cruiser



2002 - 47 Open Flybridge SI



2001 - M430 Sport Cruiser



1997 - 34 Open Flybridge



1997 - 4000 Offshore Enclosed



1997 - 4000 Offshore Open



1996 - 43 Open Flybridge



1996 - 40 Open Flybridge Aft Cab



1996 - 39 Open Flybridge



1995 - 3300 Open Flybridge



1993 - 48 Enclosed Flybridge SI



1988 - 52 Enclosed Flybridge



1987 - 35 Open Flybridge



1987 - 34 Diavalo



1987 - 33 Open Flybridge



1987 - 27 Open Flybridge



1986 - 38 Open Flybridge MK II



1985 - 52 Open Flybridge



1985 - 46 Open Flybridge

RivieraAustralia.com

